

Matala[®] filter media

Think Progressive!

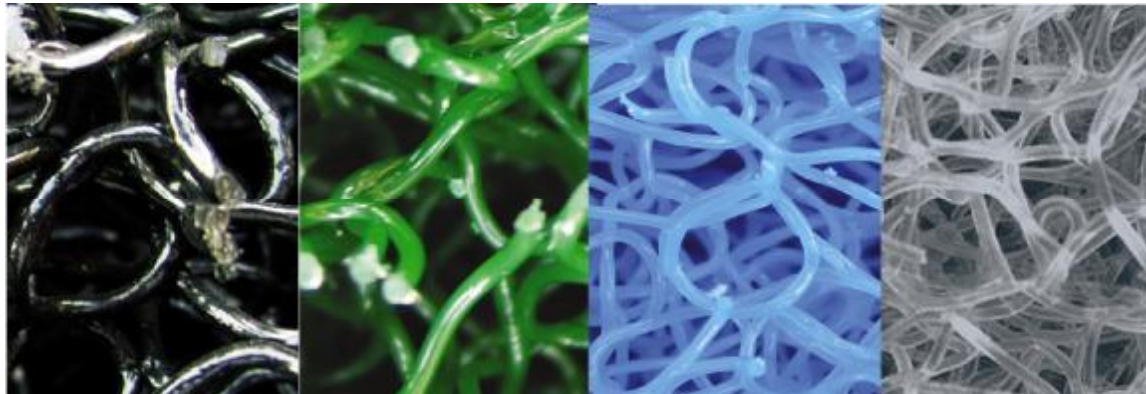

APPLICATION FIELDS:

- Ø Industrial Waste Water treatment
- Ø Domestic sewage treatment
- Ø Storm water treatment
- Ø Recirculation systems for Aquaculture
- Ø Aeration plants
- Ø Bio-scrubbers and cooling towers
- Ø water-oil separation
- Ø Marine habitat rehabilitation

AVAILABLE FORMS : IN SHEETS, ROLLS, PIPES, RINGS

Suggest design parameters:

surface loading :	5-10g BOD/m ² -day
Total surface area filtration	1500m ²
sludge removal caculation:	≅ 16g BOD ₅ / m ² -d@537 m ² (in tank center)
sludge removal calculation:	≅ 5.6g/ m ² -d@1514 m ² (for completed tank)
organic loading	0.5-1.0 kg BOD/m ³ -d

BHB ASIA TECHNOLOGY CO., LTD.

Tel. +886 4 2630-4015 Fax +886 4 2630-4067

www.bhbasia.com e-mail. : info@bhbasia.com

121 Tzu Li 2ST, Wu Chi Town, Taiwan

Hakko Japan Small Domestic wastewater treatment systems
 BOD influent : 200mg/L BOD effluent : <20mg/L

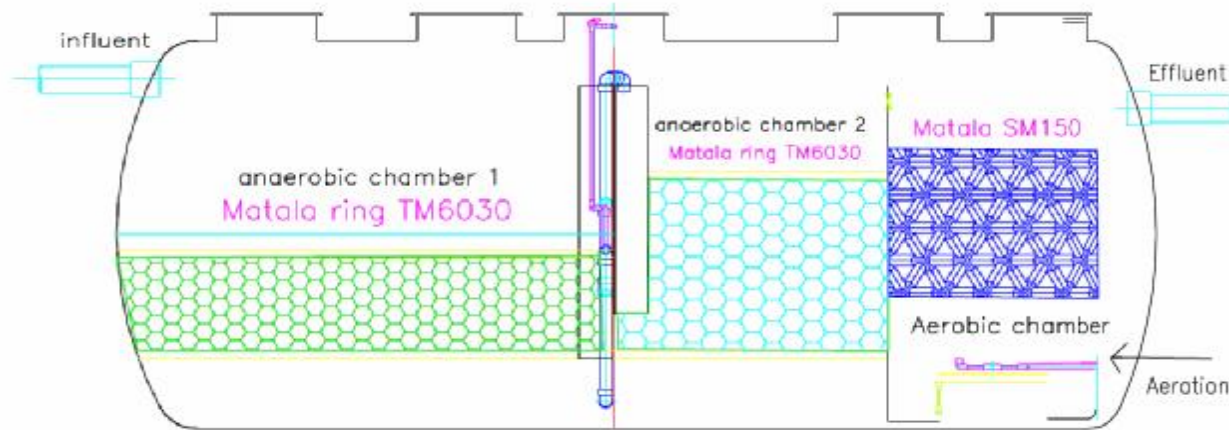

System capacity(persons)	5	20	51
flow rate (L/day)	1000	40000	10200
Effective Volume : m3			
Anaerobic Cham. 1	0.869	3.436	7.055
Anaerobic Cham.2	0.592	2.000	4.653
flow regulation cham.	0.293	2.281	0.000
fixed bed aerotion cham.	0.389	1.229	3.000
colletion cham	0.213	2.15	2.705
filter media(anaerobic chamber)	Matala TM6030	Matala TM6030	Matala TM6030
shape	ring	ring	ring
material	Polypropylene	Polypropylene	Polypropylene
dimensions (cm)	OD:7.5 , H:10	OD:7.5 , H:10	OD:7.5 , H:10
Tank filled up rate (V/V %)	>40/60	>40/60	40/60
filter media(aerobic chamber)	Matala SM150	Matala SM150	Matala SM150
shape	3-D holes structure in sheet	3-D holes structure in sheet	3-D holes structure in sheet
material	Polypropylene	Polypropylene	Polypropylene
dimensions (cm)	100x120x5	100x120x5	100x120x5
specific surface area(m2/m3)	150	150	150
Tank filled up rate (V/V%)	>64	>70	>70
air flow(L/min)	2xHK-80(aeration, cleaning)	200	>410

BELLEAQUA Belgium Submersible Aeration Filtration with CE certificated for IBA&KWZI
 BOD influent : 397mg/L BOD effluent : <6mg/L

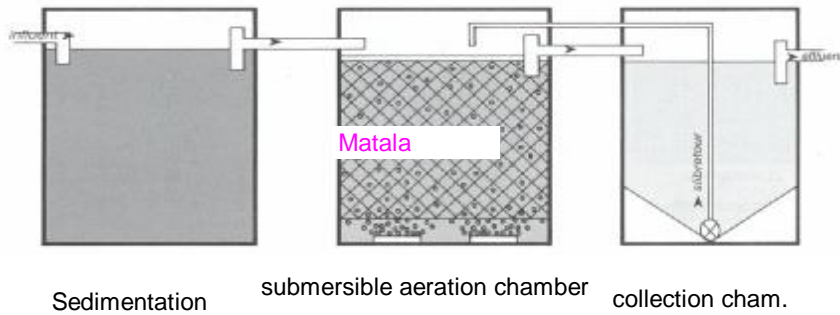

System capacity(persons)	6	20	50
flow rate (L/day)	900	3000	7500
Effective Volume : m3			
Sedimentation Cham.	1.65	8.5	20
Submersible aeration cham.	1.6	5.000	12
colletion cham	1.65	8.5	20.000
filter media(SAF) cham.	Matala SM150	Matala SM150	Matala SM150
shape	3-D holes structure in sheet	3-D holes structure in sheet	3-D holes structure in sheet
material	Polypropylene	Polypropylene	Polypropylene
dimensions (cm)	100x50x5	100x120x5	100x120x5
specific surface area(m2/m3)	150	150	150
Tank filled up rate (V/V%)	47%	47%	47%
air flow(L/min)	60		

Matala Specification

Specifications					
Matala® Type	Color	Specific surface	ave. Weight(Matala)	ave. Weight(Flex-Matala)	Free volume %
Product Code		m ² /m ³	kg/m ³ , lb/ft ³	kg/m ³	
M150 / FM150	Black	130-160	60 , 3.74	—	93
M190 / FM190	Black	180-200	67 , 4.17	83 , 5.17	92
M290 / FM290	Green	270-300	61 , 3.8	67 , 4.17	93
M360 / FM360	Blue	350-380	55 , 3.43	63 , 3.93	94
M460 / FM460	Grey	450-470	88 , 5.48	75 , 4.67	94

*Produce code of "FM" stand for Flex-Matala

Matala measurements

In Sheet			
Matala® Type	Color	Measurements (cm, in)	Measurements (cm, in)
Product Code		Matala	Flex-Matala
SM150 / FSM150	Black	120x100x5 , 48x39x1.97	—
SM190 / SFM190	Black	120x100x5 , 48x39x1.97	120x100x4.0 , 48x39x1.57
SM290 / SFM290	Green	120x100x4 , 48x39x1.57	120x100x3.8 , 48x39x1.5
SM360 / SFM360	Blue	120x100x4 , 48x39x1.57	120x100x3.8 , 48x39x1.5
SM460 / SFM460	Grey	120x100x4 , 48x39x1.57	120x100x3.8 , 48x39x1.5

*Produce code of "FM" stand for Flex-Matala

In Roll		
Matala® Type	Color	Measurement(cm, in)
Product Code		
RM150 / RFM150	Black	Height: 15-100 , 5.9-39
RM190 / RFM190	Black	Diameter: 60-200, 23.6-78.7
RM290 / RFM290	Green	
RM360 / RFM360	Blue	
RM460 / RFM460	Grey	

*Produce code of "FM" stand for Flex-Matala

In Tube		
Matala® Type	Color	Measurement (cm)
Product Code		
TM150 / TFM150	Black	Tube A ID : 4.3±0.5 , OD: 11±0.5
TM190 / TFM190	Black	
TM290 / TFM290	Green	Tube B ID : 12.6±0.5 , OD: 20±0.5
TM390 / TFM390	Blue	
TM460 / TFM460	Grey	

*Produce code of "FM" stand for Flex-Matala

*The above specifications are subject to change without prior notice